



**Access Hardware Ltd**

Architectural Stainless Steel

— *Accessories* —



*Stylishly Simple*

PRODUCT | RANGE

# Stylishly Simple

---

## Introduction

Designed to compliment our stylish lever handles, this collection gives you a wide choice of fittings for residential or commercial use.

## Material

Our stainless steel and chrome plated products are both strong and corrosion resistant. They are suitable for most applications.

Please contact our staff for further advice.

## Finish

- SSS – Satin Stainless Steel (Brushed finish)
- PSS – Polished Stainless Steel (Mirror finish)
- SC – Satin Chrome
- SN – Satin Nickel
- PC – Polished Chrome
- PA – Polished Aluminium



## H301

### 3 x 2 1/2 inch 2BB hinge\*

Double ball bearing

Finish: SSS

\*Fire rated FD30/60 (BSEN 1363-1:1999)

## H302

### 3 x 2 inch 2bb hinge

Double ball bearing

Finish: SSS, PSS

## H303

### 3 x 2 inch Washered hinge

4 washers

Finish: SSS, PSS



## H401

### 4 inch CE stamped hinge

Available:

4" x 3" x 2.5mm

Corner: Straight, Radius

Finish: SSS, PSS

Grade 13 and Fire Rated FD30/60

(BS EN 1935:2002/AC:2003)



# Locks & Latches

---

## L01

### Bolt through Tubular Mortise Latch

Suitable for all types of sprung lever furniture

Available sizes:

2.5 inch, 45mm backset

3 inch, 57mm backset

**Finish:** SS forend and strike plate. Dust socket included.

Fire rated: FD30/60

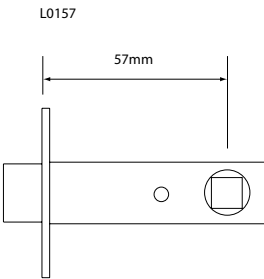
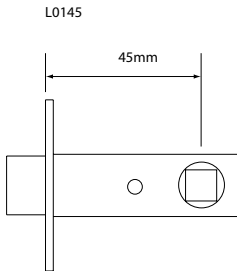

## L50

### Bolt through Mortise Bathroom Latch

Suitable for all types of sprung door furniture

Available sizes:

2.5 inch, 45mm backset

3 inch, 57mm backset

**Finish:** SSS forend and strike plate



# Cabinet Handles

## P1101

### C Cut out cabinet handle

Available sizes:

192mm c/c

320mm c/c

Finish: PA

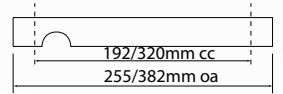

## P1102

### D Cut out cabinet handle

Available sizes:

192mm c/c

320mm c/c

Finish: PA

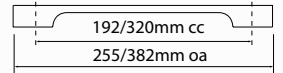

## P1103

### Curved cabinet handle

Available sizes:

160mm c/c

192mm c/c

Finish: PA

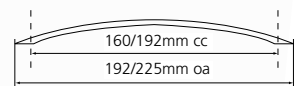

# Cabinet Handles

---



## P1200

### D Shaped tubular cabinet handle

Available:

10 x 96mm cc – PC, SC, SN

10 x 100mm cc – SSS, PSS

10 x 500mm cc – SSS, PSS, PC, SN



## P1104

### Bow shaped Cabinet Handle

Available:

10 x 128mm cc

10 x 192mm cc

10 x 288mm cc

Finish: PC, SN



## P1105

### T Bar Cabinet Handle

Available:

10 x 64mm cc, 124mm oa

10 x 160mm cc, 220mm oa

10 x 256mm cc, 335mm oa

10 x 416mm cc, 495mm oa

10 x 640mm cc, 720mm oa

Finish: PC, SN



**X2001**  
**Male sign**  
75mm Diameter  
Screw Fixings supplied  
Finish: SSS, PSS



**X2002**  
**Female sign**



**X2003**  
**Disabled sign**



**X2004**  
**Unisex sign**



**X2005**  
**Shower sign**



**X2006**  
**W/C sign**



**X2007**  
**Baby Change sign**



**X2020**  
**Fire door keep shut sign**



**X2021**  
**Fire door keep locked sign**



**X2022**  
**Automatic fire door keep clear sign**

# Numerals

---



**X2130**  
**Numerals 0-9**

75mm high  
Screw fixings supplied  
**Finish:** SSS, PSS



**X2131**  
**Letters A-D**

75mm high  
Screw fixings supplied  
**Finish:** SSS, PSS



## X2875 Wall door stop

16 x 75mm

Screw Fixing supplied

Finish: SSS, PSS

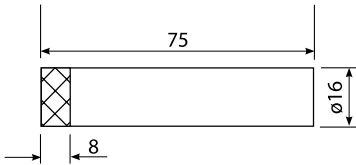

## X2876 Wall door stop on rose

16 x 75mm door stop

50 x 8mm concealed rose

Screw fixings supplied

Finish: SSS, PSS

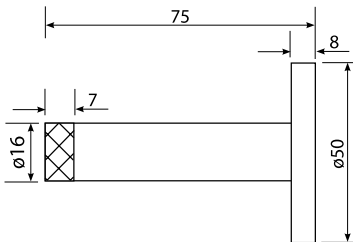

## X2877 Skirting Door Stop on Rose

75mm projection on a small face fix rose

Screw fixings supplied

Finish: SSS, PSS

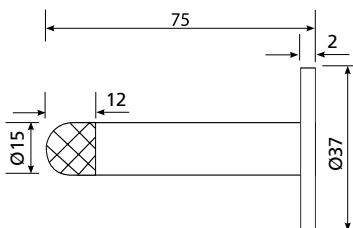

# Door Stops

---

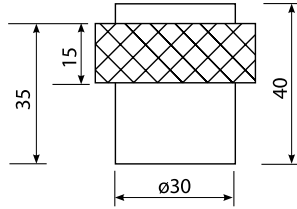

## X2830 Floor door stop

30mm Diameter

Screw fixing supplied

Finish: SSS, PC, PSS, SC

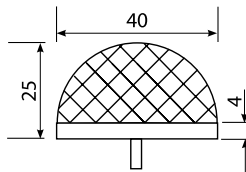

## X2840 Oval door stop

40mm diameter

Screw fixing supplied

Finish: SSS, PC, SC

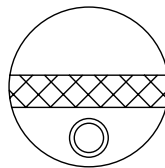

# Letter Plates

## X9412

### Letter Plate

305 x 102mm Sprung

Bolt through fixings supplied

Grade 316 Stainless Steel

Finish: SSS, PSS

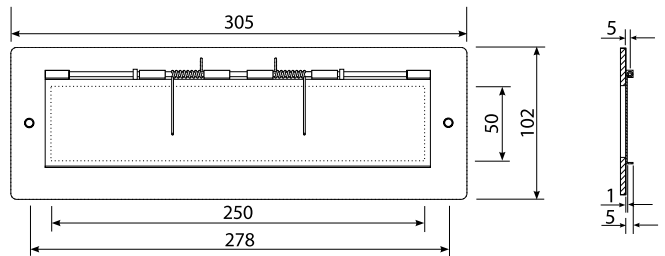
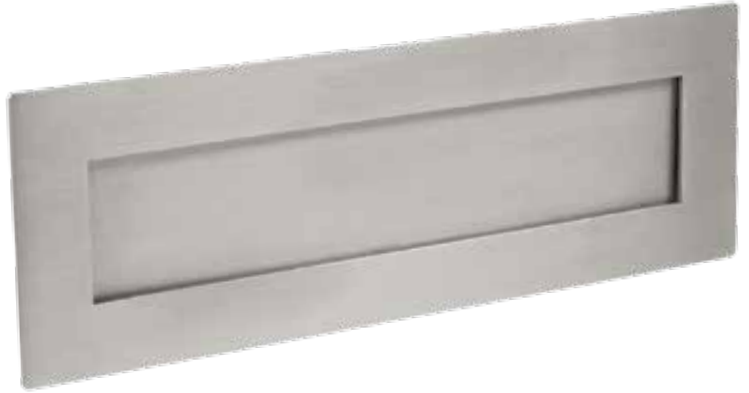

## X95

### Internal letter tidy

Available:

280 x 80mm

320 x 90mm

Screw fixings supplied

Finish: SSS, PSS

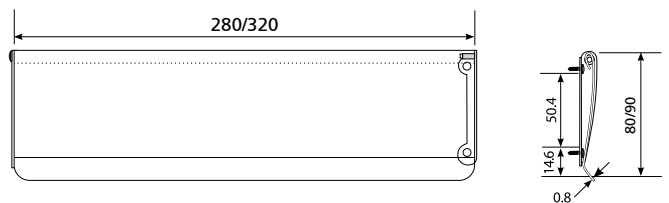

# Finger Plates

---

X25

## Finger plate

Available:

300 x 75mm

300 x 75mm printed push

350 x 75mm

450 x 75mm

Screw fixings supplied

**Finish:** SSS, PSS



## T510

### Coat Hook, buffer

44mm Projection

Screw Fixings supplied

Finish: SSS, PSS

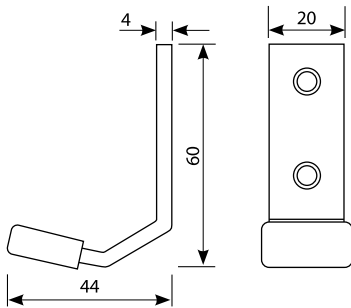

## T521

### Hat and coat hook, buffer

44mm Projection

Screw fixings supplied

Finish: SSS, PSS

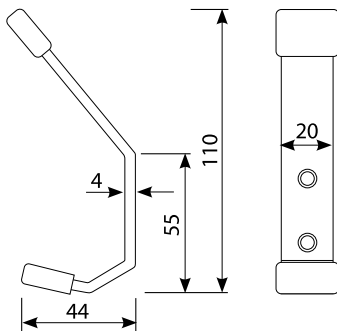

# Accessories

---

## X40 19mm Flush Bolt

150 x 19mm

200 x 19mm

250 x 19mm

Fixings supplied

Finish: SSS, PSS

## X41 25mm Flush Bolt

200 x 25mm

Fixings supplied

Finish: SSS



## X705 Euro Profile Cylinder Pull

30mm projection

Grade 316 for external doors

Screw fixings supplied

Finish: SSS, PSS



## Guarantee

Access Hardware guarantees the products in this catalogue against defects in workmanship and materials subject to fair wear and tear in standard atmospheric conditions for a period of 10 years.

Access Hardware assumes no liability for:

- Improper installation or failure to follow fitting instructions.
- Improper maintenance or unfair wear and tear.
- Indirect or consequential loss or damage.
- Cost of removal and/or replacement.
- Cost of freight and/or travelling expenses.
- Although our products are suitable for most applications, no finish is unconditionally guaranteed and advice should be sought from one of our representatives.

## Care and Maintenance

To retain the highest corrosion resistance it is necessary to keep the surface of stainless steel clean. This can be done by wiping with a clean cloth using either a mild detergent or soap, then rinsing with warm clean water and drying with a towel. Carbon steel brushes or wire wool should not be used. Comprehensive instructions are available upon request.

## Change of Product Specifications

As a result of continuous improvements to our products, we reserve the right to alter standard product specifications and dimensions without prior notice.



*Stylishly Simple*



**Access Hardware Ltd**

Green Lane | Studley | Warwickshire | B80 7EY

Tel: 01527 852 948 | Fax: 01527 854 192

Email: [sales@accesshardware.co.uk](mailto:sales@accesshardware.co.uk)  
[www.accesshardware.co.uk](http://www.accesshardware.co.uk)

Contact Distributor